

# Airflo

## Instruction Manual



Stick Vac

### 1 Warnings

Before using this appliance, read and follow all warnings and instructions in this manual, even if you are familiar with this product.

This appliance is not intended for use by persons (including children) with reduced physical, sensory or mental capabilities, or lack of experience and knowledge, unless they have been given supervision or instruction concerning use of the appliance by a person responsible for their safety.

Young children should be supervised to ensure that they do not play with the appliance.

### 2 Safety Reminders

Please read this instruction manual carefully before first use. It is advisable to keep this instruction manual for future reference.

**DO NOT** vacuum water, wet objects, liquids, ashes, hot coals, cigarette butts, matches or any hot, smoking or burning objects, etc.

**DO NOT** pick up flammable or combustible materials (i.e. lighter fluid, petrol, kerosene, etc.) or use in the presence of explosive liquids or vapour.

**DO NOT** pick up toxic material (i.e. chlorine bleach, ammonia, drain cleaner, etc.)

**DO NOT** vacuum Toner (for laser printer, copy machines etc.) as there is a risk of fire and explosion.

**DO NOT** vacuum plaster, cement etc. as the filter can become blocked.

**DO NOT** use the vacuum without all the filters fitted.

**DO NOT** store or use the appliance near high temperature areas.

**DO NOT** run over the power cord with the vacuum cleaner.

**DO NOT** use the vacuum cleaner if it is blocked. Turn off and clear all blockages before continuing.

**DO NOT** use the vacuum cleaner with blocked filters. Clean filters before continuing. (refer to User Maintenance section).

**DO NOT** use the vacuum cleaner if the appliance malfunctions; has an abnormal noise or smell; is emitting smoke; or if you dropped or damaged it in any manner or any breakage is found during operation.

Return appliance to the nearest authorised service agent or similarly qualified person for a thorough examination, repair, electrical or mechanical adjustment.

**DO NOT** misuse the cord. Never pull the appliance by the cord or pull to disconnect it from the outlet. Instead, grasp the plug and pull to disconnect.

2

**DO NOT** use the vacuum cleaner to pick up large objects, hard or sharp objects such as glass, nails, screws, coins, etc. that are likely to cause damage.

**DO NOT** leave unattended when plugged in and / or switched on.

**DO NOT** use vacuum cleaner if it has been dropped, damaged, left outdoors, or dropped into liquid (water etc.)

**DO NOT** close door on cord, or pull cord around sharp edges or corners.

**DO NOT** handle plug or vacuum cleaner with wet hands.

**DO NOT** put any objects into openings.

**DO NOT** use with any openings blocked and do not restrict airflow.

**DO NOT** operate the appliance with a damaged cord or plug.

If the supply cord is damaged, it must be replaced by the manufacturer, its service agent or similarly qualified persons in order to avoid a hazard.

**DO NOT** use without filters in place.

**DO NOT** attempt to modify this product in any way.

**DO** empty the Dust Canister regularly for optimal operation of the vacuum.

**DO NOT** use the appliance without the filters being installed.

**DO** keep hair, loose clothing, fingers, feet and body parts away from openings or moving parts.

**DO** turn off controls before you connect or disconnect the appliance to or from the mains supply.

**DO** disconnect the appliance from the power supply when not in use, before changing the dust filter, cleaning the filters or connecting / disconnecting the accessories.

**DO** use only on dry, indoor surfaces.

**DO** use only as described in this manual. Use only manufacturer's recommended attachments.

**DO** keep cord away from heated surfaces.

**DO** keep all openings free of dust, lint, hair, and anything that may reduce airflow.

**DO** use extra care when vacuuming on stairs.

**DO** keep your work area well lit.

**DO** store your appliance indoors in a cool, dry area.

**DO** ensure children and babies refrain from playing with the plastic bags or any

3

packaging materials.

**DO** operate the appliance from a power source of the same voltage, frequency and rating as indicated on the product identification plate

If this appliance is used by a third party, **DO** supply the instruction manual with it.

No liability can be accepted for any damage caused by non-compliance with these instructions or any other improper use or mishandling of appliance.

This product has not been designed for any uses other than those specified in this manual.

**ONLY** for domestic use. Industrial or commercial use invalidates the warranty.

## Read and Save These Instructions

### 3 Transporting your Vacuum

To move your vacuum cleaner from room to room, unplug the unit and carry using the carry handle.

Never pull or carry the vacuum cleaner by its cord.

4

### 4 Parts

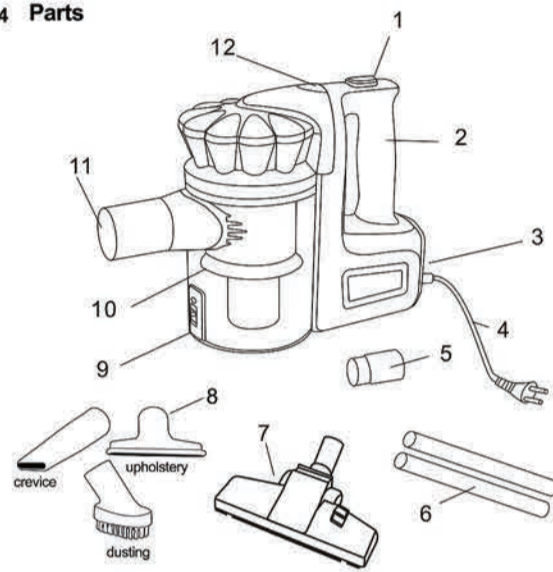

- |                       |                   |                                  |
|-----------------------|-------------------|----------------------------------|
| 1. On / off button    | 5. Connector      | 9. Dust release button           |
| 2. Handle             | 6. Extension tube | 10. Filtration net               |
| 3. Wind output grille | 7. Floor brush    | 11. Inlet                        |
| 4. Power cord         | 8. Tools          | 12. Dust canister release button |

Note: The specifications and/or components of the appliance are subject to change without prior notice.

5

### 5 Assembly Method

Note: Before assembly, please ensure that you have received all parts listed in the parts list.

Note: Always transport / send the appliance in its original packaging so that it does not become damaged.

Note: Always remove the plug from the power socket before fitting or removing accessories.

#### 5.1 Fitting tube and accessories(PIC.1)

- Insert the connector(1) into inlet on appliance.
- Connect the end of 1pc tube with connector.
- Connect 2pcs of tube(2).
- Insert another end of tube into the floor brush head(3).

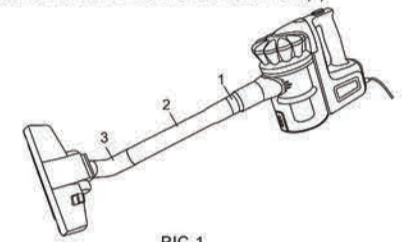

#### 5.2 Tools (PIC.2)

- Insert the connector(1) into inlet on appliance.
- Connect tool(2) with connector.

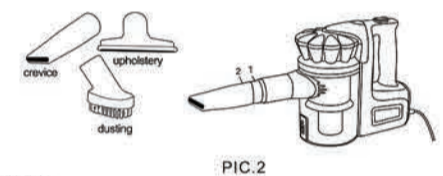

### 6 Controls

#### 6.1 Power and Power cord

- Untie the cord, insert the plug into the power supply
- Press the On /Off button to start the motor.
- After using, unplug and tie the cord together.

6

### 7 Emptying the Dust Canister

Empty the Dust Canister as frequently as possible or when the suction power is reduced.

WARNING: The plug must be removed from the power socket before emptying.

#### 7.1 Emptying Method I:

Hold the appliance over a dustbin, press the dust release button to open bottom and release the dirt (PIC.3).

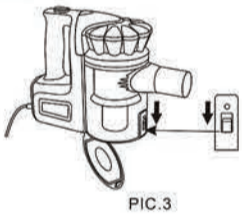

PIC.3

#### 7.2 Emptying Method II

• Remove the dust canister from the product by pressing dust canister release button (PIC.4) and pulling the dust canister away from the product as the arrowhead shown. (PIC.5)

• Holding the dust canister over a dust bin, press the dust release button as shown (PIC.6), the bottom of the dust canister will drop down to release the dirt.

• Close the bottom of the dust canister by pressing the base upwards until it clicks into place.

• Push the dust canister back onto the product by insert into the slot until it clicks into place.

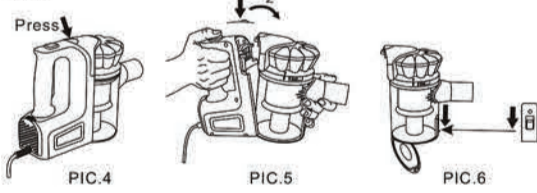

PIC.4

PIC.5

PIC.6

7

### 8 Cleaning the filters and filtration net

Warning: when the filters are obviously covered with dust or the suction decreases considerably, Please clean it in time, for this can improve the working efficiency and extend the lifetime of the cleaner.

Never use the cleaner without filters.

IMPORTANT: Please put the cleaner on the floor before you clean the filter.

• Remove the dust canister from the product by pressing dust canister release button and pulling the dust canister away from the product.

• Unscrew the cover counterclockwise (PIC.7), take out the filters (PIC.8) and filtration net (PIC.9).

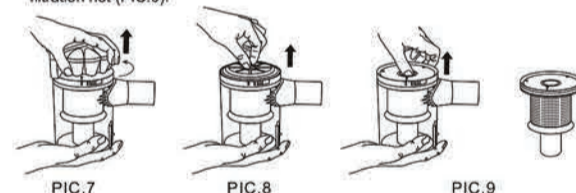

PIC.7

PIC.8

PIC.9

#### Exhaust Air Filter (PIC.10)

The exhaust air filter cleans the air a final time before it leaves the vacuum cleaner.

You can access and clean the exhaust air filter as follows: this is located at the rear of the vacuum cleaner inside the grille.

Unclip the grille by pressing the tab downward and remove to expose the filter inside the grille.

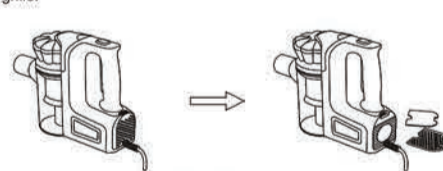

PIC.10

8

- For the easy clean, hold the filters and/or filtration net over a dustbin, knock gently against all sides. If needed, rinse them under the tap (PIC.11). Pls use a soft brush to clean the filters.

Important: Hard brush will damage to the filters.



PIC.11

NOTE: After cleaning, the filtration material must be completely dry before re-assembling into the product to avoid any possible damage to the products. We suggest leaving it in open air for at least 24hours after cleaning.

### 9 Refit the filters and filtration net

- Refit the filtration net into the bowl by lining up the triangle mark (on top plate of net) and the line mark on the side of bowl. (PIC.12)

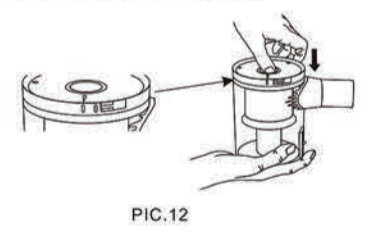

PIC.12

9

- Put the filters back on the top plate of filtration net (PIC.13), then close the cover clockwise by lining up the triangle mark (on the side of cover) and the line mark on the side of bowl (PIC.14).

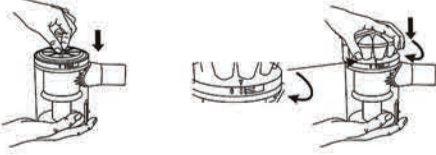

PIC.13

PIC.14

- Refit the dust canister in to the vacuum cleaner, simply align the dust canister into its position (PIC.15) and close until it locks in place (PIC.16).

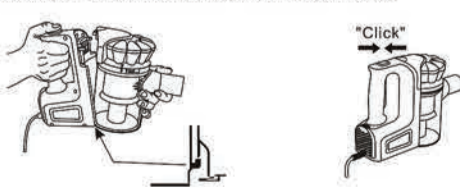

PIC.15

PIC.16

- Refit the exhaust air filter to its place, close the grille (PIC.17).

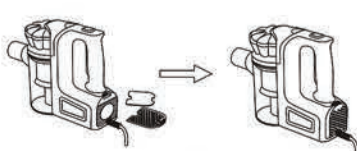

PIC.17

10

### 10 User Maintenance

WARNING: The plug must be removed from the power socket before any maintenance or replacement.

NOTE: To maximize the performance of your vacuum cleaner, you should clean your filters regularly.

### 11 Important for cleaning

- The Filters must be cleaned regularly for best suction performance and to prevent over-heating and damage to your vacuum cleaner.

• Cleaning is best done at the same time when emptying the dust canister after you have finish vacuuming for the day.

NOTE: Never use the vacuum cleaner with wet or damp filters or without ALL filters fitted.

- Wash the filters in warm mild soapy water, rinse in clean fresh cold water and let completely dry.

• Rinse the filtration net in the lukewarm water and let completely dry.

• Using wet or damp filters will damage the filters, may cause serious damage to the vacuum cleaner and will void your warranty.

Do not use a hair drier to dry the filters.

Do not clean the vacuum cleaner, components or accessories using petrol or any other flammable liquid or solvents, etc.

Clean only the outside of the vacuum cleaner.

Use only a moist cloth and mild detergent for cleaning the vacuum cleaner.

After cleaning, wipe off the moisture on vacuum cleaner, components and accessories with a dry cloth.

Do not place accessories, tool or components in a dishwasher.

11