

AIRFLO[®]

INSTRUCTION MANUAL



Handheld Vac
AFV201

IMPORTANT SAFETY REMINDERS

- This appliance should be for domestic use only, as described in this users' guide. Please ensure that this manual is fully understood before using the appliance.
- This appliance is not intended for use by persons (including children) with reduced physical, sensory or mental capabilities, or lack of experience and knowledge, unless they have been given supervision or instruction concerning use of the appliance by a person responsible for their safety. Children should be supervised to ensure that they do not play with the appliance.
- To ensure the continued safe and efficient operation of this appliance, we recommend that any servicing or repairs are only carried out by an authorised service agent.
- Do not vacuum water, wet objects, liquids, ashes, hot coals, cigarette butts, matches or any smoking or burning objects.
- Do not pick up flammable or combustible materials.
- Do not vacuum plaster, cement, etc as the filter can become blocked.
- Do not use the vacuum without all the filters fitted.
- Do not store or use the appliance near high temperature areas.
- Do not run over the power cord with the vacuum cleaner.
- Do not use the vacuum cleaner if it is blocked. Switch it off and clear all blockages before continuing.
- Do not use the vacuum cleaner if the appliance emits an abnormal noise or a burning smell.
- Do not handle the unit or connect/disconnect the plug with wet hands. Also, do not disconnect by pulling on the cord. Grasp the plug and pull to disconnect.
- Do not use the vacuum cleaner to pick up large objects, or hard or sharp objects (e.g. glass, nails, screws, coins, etc).
- Do not leave unattended when plugged in and / or switched on.
- Do not use vacuum cleaner if it has been dropped, damaged, left outdoors or dropped into liquid.
- Do not close door on cord or pull cord around sharp edges or corners.
- Do not put any objects into openings.
- Do not use with any openings blocked. Do not restrict airflow.
- Do not operate the appliance with a damaged cord or plug. If the supply cord is damaged, call the manufacturer, its service agent or similarly qualified person in order to avoid any hazard.

- Do not use without filter in place.
- Do not attempt to modify this product in any way.
- Do not use the appliance without the filters being installed.
- Empty the dust canister regularly for optimal operation of the vacuum.
- Keep hair, loose clothing, fingers, feet and body parts away from openings or moving parts.
- Turn off controls before you connect or disconnect the appliance to or from the mains supply.
- Disconnect the appliance from the power supply when not in use, before changing the dust filter, cleaning the filters or connecting/disconnecting the accessories.
- Use only on dry, indoor surface.
- Use only as described in this manual and only manufacturer's recommended attachments.
- Keep all openings free of dust, lint, hair, and anything that may reduce airflow.
- Use extra care when vacuuming on stairs.
- Keep your work area well lit.
- Store your appliance indoors in a cool, dry area.
- Ensure children and babies do not play with plastic bags or any packaging materials.
- Operate the appliance from a power source of the same voltage, frequency and rating as indicated on the product identification plate.
- No liability can be accepted for any damage caused by non-compliance with these instructions or any other improper use or mishandling of appliance.
- This product has not been designed for any uses other than those specified in this manual.
- Only for domestic use. Industrial or commercial use invalidates the warranty.

READ AND KEEP THIS INSTRUCTION MANUAL

- When moving your vacuum cleaner from room to room, unplug the unit and carry using the carry handle. Never pull or carry the vacuum cleaner by its cord.
- **WARNING:** The plug must be removed from the power socket before any maintenance or replacement.
- To maximize the performance of your vacuum cleaner, clean your vacuum's filters regularly.

PARTS

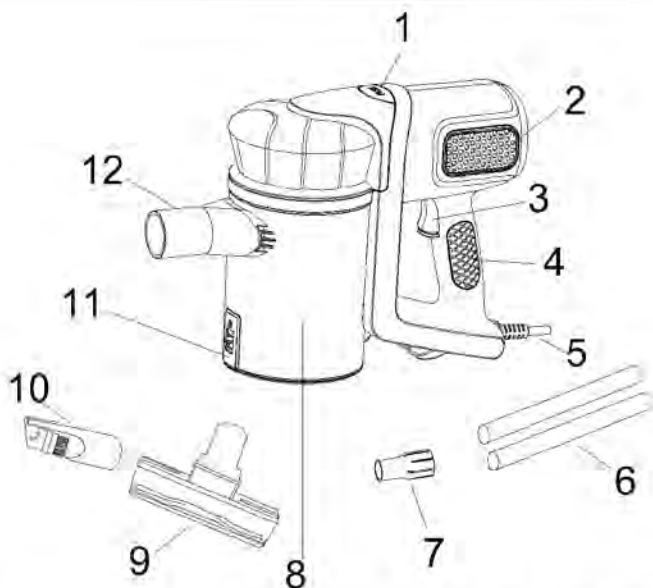

- | | | |
|------------------------|------------------|-------------------------|
| 1. Dust release button | 5. Power cord | 9. Floor brush |
| 2. Air output grill | 6. Rod | 10. Filtration net |
| 3. On / Off button | 7. Connector | 11. Dust release button |
| 4. Handle | 8. Dust canister | 12. Inlet |

ASSEMBLY

Note: Before assembly, please ensure that you have received all parts listed in the parts list.

Always remove the plug from the power outlet before fitting or removing accessories.

Fitting the rod and accessories (picture 1)

1. Insert the connector (1) into inlet on appliance.
2. Connect one end of the rod to the connector.
3. Connect the rods (2).
4. Insert another end of the rod into the floor brush head (3).

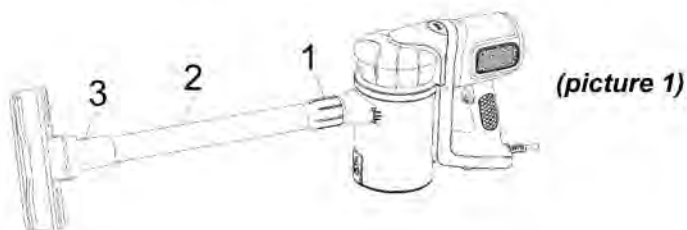

Tools (picture 2)

The **Crevice tool is used for cleaning down the sides of sofas and into corners, etc. The Crevice tool with brush is used for cleaning grills and vents, etc.

1. Insert the connector (1) into inlet on appliance.
2. Connect tool (2) with connector.

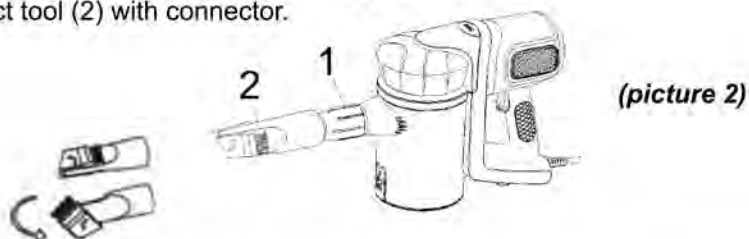

HOW TO USE YOUR VACUUM CLEANER

Power and Power cord

1. Untie the cord, insert the plug into the power supply
2. Press the On /Off button to start the motor.

***After using, unplug and tie the cord together.

Using the cleaning accessories

1. Dual-position carpet/ floor brush.

Position 1: Bristles extended, for hard floors (picture 4)

Position 2: Bristles retracted, for carpets (picture 5)

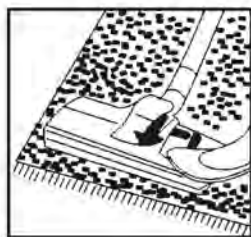



***** Narrow nozzle**
For cleaning radiators, corners, edges, drawers, etc.



***** Small brush**
For cleaning curtains, shelves, books, delicate objects, etc.

CLEANING AND MAINTENANCE

Emptying the Dust Canister

Empty the Dust Canister as frequently as possible or when the suction power is reduced. **WARNING:** The plug must be removed from the power socket before emptying.

Emptying Method 1: Hold the appliance over a dust bin, press the dust release button to open bottom and release the dirt (**picture 6**).

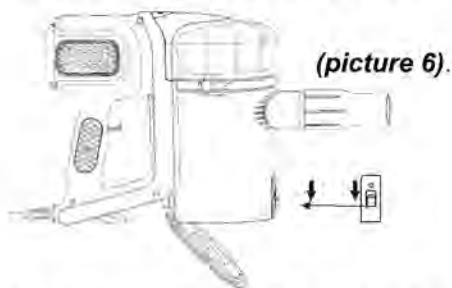

Emptying Method 2: 1. Remove the dust canister from the product by pressing the release button (**picture 7**) and pulling the dust canister away from the product as the arrowhead shows. (**picture 8**)

2. Holding the dust canister over a dust bin, press the dust release button as shown (**picture 9**). The bottom of the dust canister will drop down to release the dirt.

3. Close the bottom of the dust canister by pressing the base upwards until it clicks into place.

4. Push the dust canister back onto the product by inserting into the slot until it clicks into place.



(**picture 7**).



(**picture 8**).

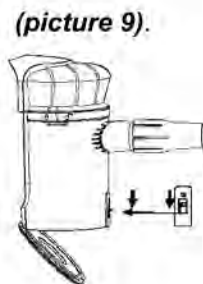

(**picture 9**).

Cleaning the filters and filtration net

Warning: when the filters are obviously covered with dust or the suction decreases considerably, clean the vacuum immediately as this can improve the working efficiency and extend the lifetime of the cleaner.

- Never use the cleaner without filters.
 - Place the cleaner on the floor before you clean the filter.
1. Remove the dust canister from the product by pressing dust canister release button and pulling the dust canister away from the product.
 2. Unscrew the cover counterclockwise (**picture 10**). Take out the filters (**picture 11**) and filtration net (**picture 12**).

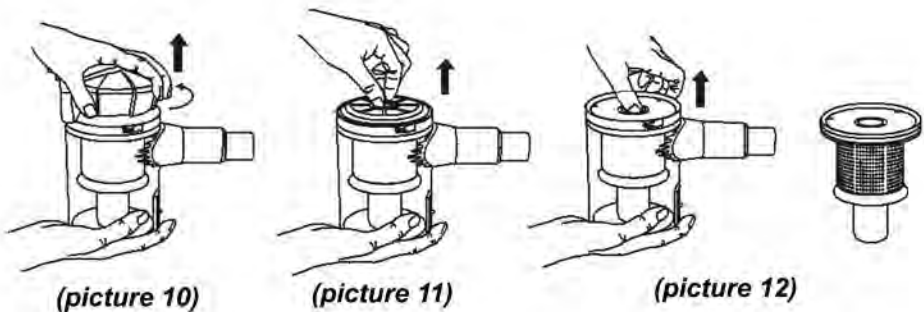

For easy cleaning:

1. Hold the filters and/or filtration net over a dust bin, knock gently against all sides. If needed, rinse them under the tap (**picture 13**). Use a soft brush to clean the filters.
Note: Hard brush will damage filters.

2. After cleaning, the filtration material must be completely dry before re-assembling to avoid any possible damage to the product.

* It is advisable to leave the filter to dry in open air for at least 24 hours after cleaning.



For the exterior of the vacuum cleaner:

- Use only moist cloth and mild detergent.
- After cleaning, wipe off the moisture on vacuum cleaner, components and accessories with a dry cloth.
- Do not place accessories, tool or components in a dishwasher.